

PLANCHONELLA HOUSE

热带雨林之家

室内设计 / Anne-Marie Campagnolo 建筑设计 / Jesse Bennett
摄影 / Sean Fennessy 编译 / 范嘉苑 美编 / 彭旭华

项目地址 澳洲
项目面积 280m²
设计单位 Jesse Bennett Architect Builder





Jesse Bennett (左) & Anne-Marie Campagnolo (右)
澳洲 Jesse Bennett Architect Builder 建筑师 & 室内设计师

本案位于澳洲昆士兰的热带雨林中，业主是本案的建筑设计师 Jesse Bennett，他的妻子 Anne-Marie Campagnolo 则负责房子的室内设计。住宅的设计理念十分简单，就是在其内部打造一系列让人感到欢愉的空间，丰富日常生活，并给这对设计师夫妇带来灵感。建筑采用了实验性的设计手法，与周围环境融为一体，拥抱着古老却富有生气的热带雨林。设计师希望用简洁的设计与明亮的调性来呈现一座原始而富有魅力的住宅。

建筑的主体由混凝土制成，并勾勒出了不规则的弧线形轮廓。房檐采用了凹陷式的结构，规避过于凌厉和突出的线条，以减少冲突感，与自然环境保持协调。房子的总体高度低于周围的树木，犹如融入于山林之间，没有凌驾于自然之上的感觉，反倒多了几分亲和力。与此同时，还保证了最佳的观景角度，从住宅向外眺望，能俯瞰美丽的热带雨林绿景。建筑的两条翼状带呈90度分布，远远望去就像悬于空中，成为树木的一部分。

宽敞的屋顶花园上方采用了大片的悬臂屋檐设计，犹如一扇热带雨林的顶棚。室内空间则尽可能地减少墙面及柱体元素，让各空间之间形成开敞流通的格局，不会对光线和视线造成过多的阻挡。通过采用这种无障碍的布局以及安装一系列的玻璃门窗，让室内外的景色无缝交融，形成开阔的空间视觉效果，营造出完全身处于雨林中、被美丽景色所“吞没”的超现实调性。室内的家具及软装陈设也经过了精心设计，例如角落一侧的粉色布艺沙发是按照建筑轮廓定制设计的，蜿蜒曲线结合柔美的色调，让客厅一角流露出优雅精致的美。起居室与卧室之间的书架也是两个空间的隔门，将柜门一侧打开便能进入主卧空间。主卧的床头板背后是一大片富有热带风情的墙纸，与周围的雨林环境相得益彰。在建造过程中，两位设计师始终坚持以功能性及被动设计原则作为主要的设计手段，旨在打造出与自然相协调又功能齐全的住宅。

被环绕在建筑内部的小庭院是整座居所的“肺脏”，它就像是业主一家提供阳光、流通空气、快乐、活动、娱乐和视觉享受的一片绿洲。这里种有青草和绿植，不仅与周围的雨林景色相互呼应，同时也将室内的各个空间连接起来，成为整座房子的中心据点，也让这对设计师夫妇多了一片休闲漫步的空间。





Planchonella House was designed with a simple idea in mind – to create a series of joyful spaces to inspire and enrich daily life. Set in tropical north Queensland, the house embraces the heritage rainforest surrounds and utilises experimental passive design methods. The simplistic approach and use of Lo-Fi technologies results in a raw and honest dwelling.

Contours of the site ridgeline have formed basis for the playful lines utilised in concrete profiles. As not to protrude out with the ridge, the profile is mirrored and cuts back in to the ridge. Visual amenity from surrounding lower areas has been maintained with this design in that rather than creating a dominant form on the landscape, it tucks back in at the critical highest most revealing point. The wings created each side of the ridge float into the surrounding rainforest and become part of the tree canopy.

The large flat roof with generous overhang acts as a rainforest canopy above, minimal walls and columns in between allow for un-obstructed views and moments to be shared with the landscape. This omission of boundaries between inside and outside gives an openness and quality of space that is surreal, living completely within and engulfed by a beautiful landscape. The resolution of plan follows a purely functional approach to use of space, privacy, visual connection and passive design principles.

The plan wraps around the courtyard space, which is considered the second hearth (after the kitchen) or perhaps lungs to the entire dwelling. The courtyard contributes much to the house and its occupants, it is an oasis that provides sun, light, ventilation, happiness, activity, visual stimulation, and entertainment. It also provides connection to the surrounding rainforest, connection from one part of the house to another, and acts as the focal node to the promenade experience of moving through the house. **M**



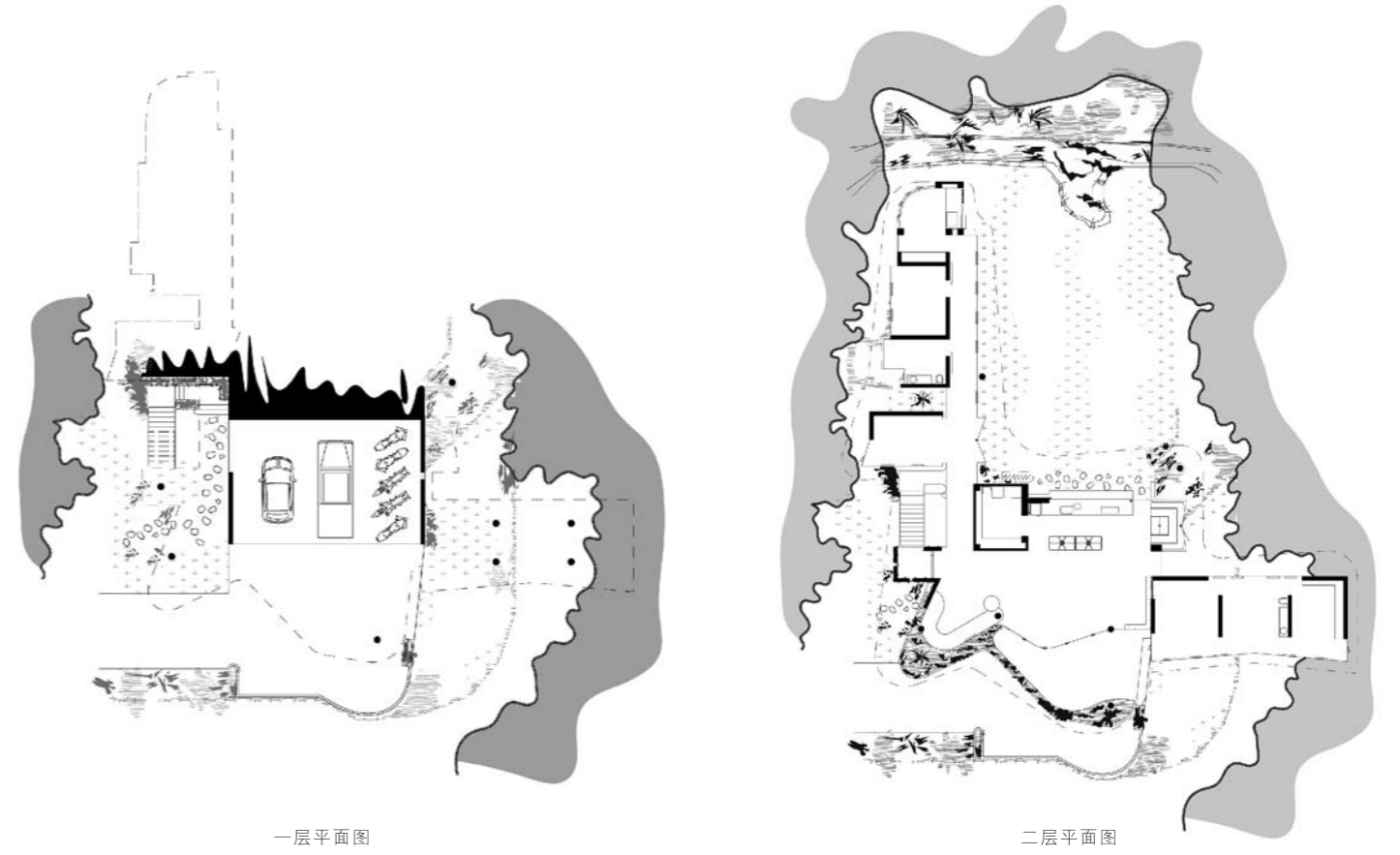



剖面图

